

HSB Product

Foundation
On Water

FFS

Floating Foundation System

The Unique Design for Floating Lifespace

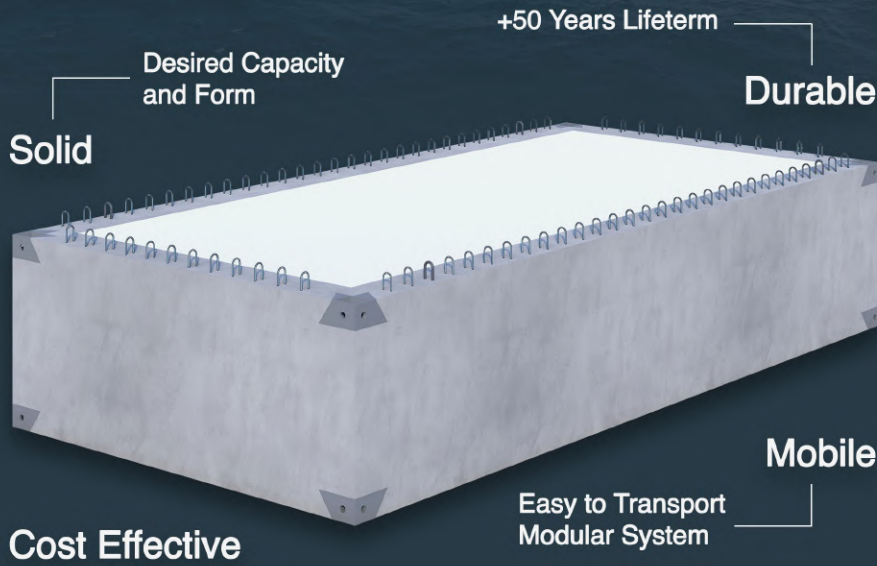

Sequence of Installation

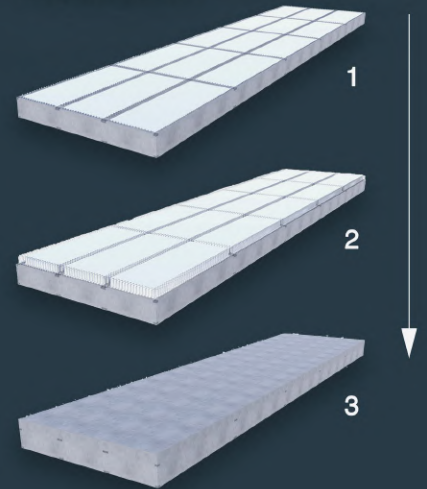

Ideal & Optimal Solution

Thanks to **FFS**, There is No Need to Fill the Sea Anyomore..

High Density EPS Core

Rebar Mesh

Module Connectors (8 pcs per module)

Concrete Cover with Reinforced Rebar

Desired Curve Shapes

Foundation of Life

- House
- Hotel
- Bridge
- Platform
- Barge
- Marina
- Palm Extension
- ⋮

City On Water

Any size & Capacity

The foundation for future, sustainable life
On Water

Optional
 Buoyancy Capacity as Needed

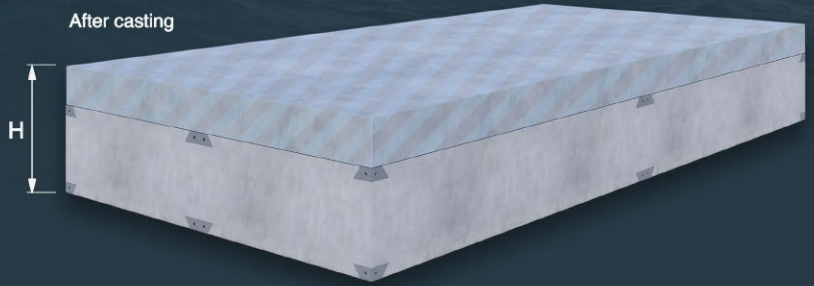
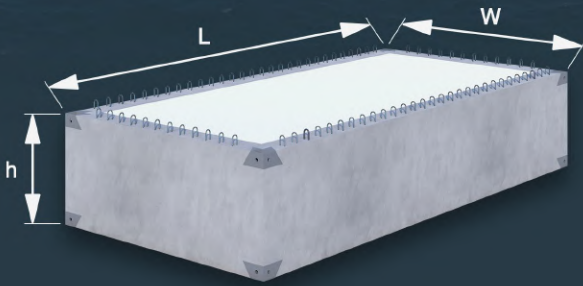

FFS Models

	Length (L)	Width (W)	Height (h)	Height (H) (after casting)	Freeboard
FFS 600 (600 kg/m ²)	4.80 (m)	2.40 (m)	1.00 (m)	1.45 (m)	0.62 - 0.63 (m)
FFS 800 (800 kg/m ²)	4.80 (m)	2.40 (m)	1.00 (m)	1.65 (m)	0.82 - 0.83 (m)
FFS 1200 (1200 kg/m ²)	4.80 (m)	2.40 (m)	1.40 (m)	2.00 (m)	1.22 - 1.23 (m)
FFS 1600 (1600 kg/m ²)	4.80 (m)	2.40 (m)	1.40 (m)	2.40 (m)	1.62 - 1.63 (m)

Images



WORLD'S
LARGEST
CONCRETE
FLOATING
STRUCTURE



2.000
SQM
2.500
TONS

